

# Wall Mounted Mono Mixer

*Product shown will vary depending on model*

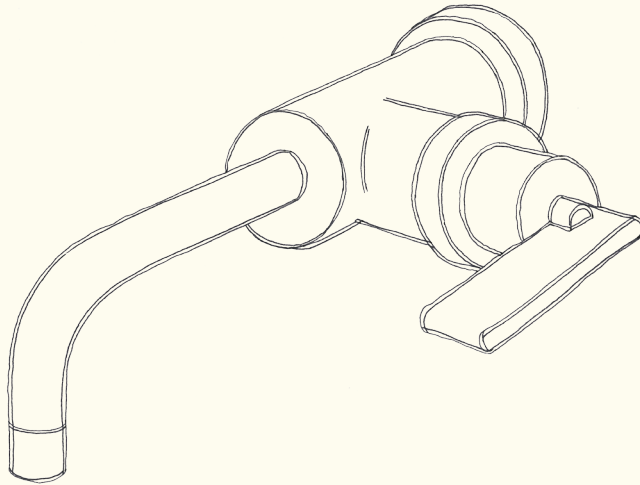

***Important information:***

To ensure this product is installed properly you must read and follow these guidelines.

The owner/user of this product must keep this information for future reference.

This product must be installed by a professional licensed contractor.

Only use a strap wrench or protected smooth jaw on any finished surface.

**ORE**

## Introduction

The model supplied may vary from the image shown. Please note that the general installation process for all wall mounted mixer fittings is the same, and the following guide will take you through the process.

The company reserves the right to continually evolve its product lines without notification. The company will not accept any liability regarding specification changes and their consequences unless previously quoted by the company in writing.

## Aftercare

During installation, extra care must be taken to avoid damaging the fitting or its finish.

## Installation Procedure

**NOTE: Certain fitting parts may vary from installation.**

1. Insert the Threaded bar into the Wall Mono Body.
2. Place fitting through the hole in the wall/splashback (ensure that the Collar and any Washers are in place prior to doing this).
3. Apply metal clamp to the back side of the stud wall.
4. Screw the Retaining Nut onto the Threaded bar and tighten until the Tap is secure.
5. Carefully install the inlet pipes (style may vary) into the fitting. It is not necessary to overtighten these pipes.
6. Earth any new pipes adequately. Seek expert advice if in doubt.
7. Connect water supply pipes to inlet pipes (ensuring isolation valves, which are not supplied, are in position).
8. Ensure Tap Valves are in the 'open' position.
9. Open Isolating Valves.
10. Turn on the water supply and allow it to run for a few minutes to flush out any debris.
11. Check for leaks.

*Only suitable for use with Stud/Partition wall.*

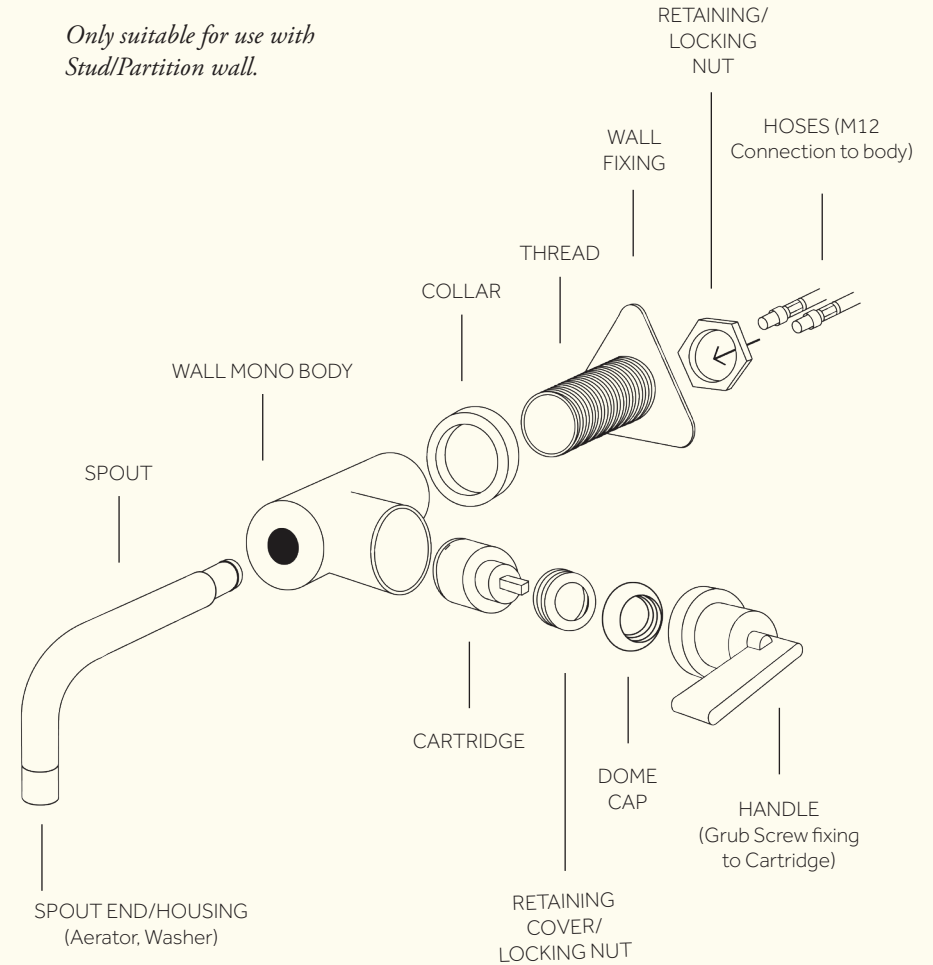

Min/Max Operating pressure: (bars)	0.5 - 3.0					
Flow rates: Bar/L per min	0.5/3.8	1/5.4	1.5/6.6	2/7.6	2.5/8.5	3/9.3
Connection:	1/2" BSP					
Flow Restrictor:	8 Ltr (TJ PCA) or 5 Ltr (USA) Aerator					

Dimensions in mm

INSTALLER DETAILS:

**ORE**