

Deck Mounted Two Hole Mixer

Product shown will vary depending on model

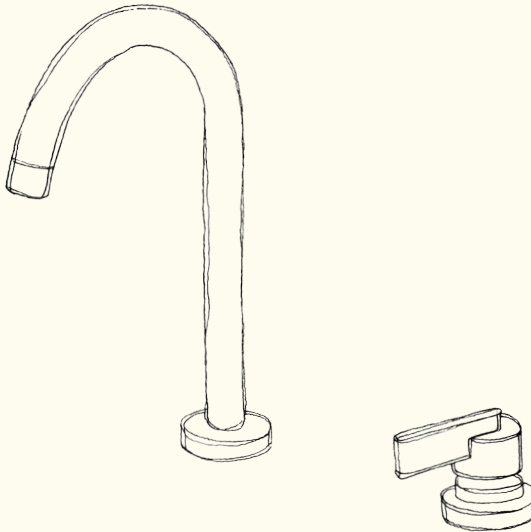

Important information:

To ensure this product is installed properly you must read and follow these guidelines.

The owner/user of this product must keep this information for future reference.

This product must be installed by a professional licensed contractor.

Only use a strap wrench or protected smooth jaw on any finished surface.

ORE

Guarantee and Aftercare

When installing or using tools, extra care must be taken to avoid damaging the finish or fitting. To maintain the appearance, please ensure it is cleaned regularly using a clean soft damp cloth only. Abrasive cleaners or detergents must not be used as they may cause surface deterioration. The company provides a guarantee against faulty material or manufacture excluding serviceable parts, providing they have been installed, cared for and used in accordance with our instructions.

More information on our Warranty and Aftercare can be found on our website.

Earth Bonding

Earth any new pipe satisfactorily (seek expert advice if in doubt).

The company reserves the right to continually evolve its product lines without notification.

The company will not accept any liability regarding specification changes and their consequences unless previously quoted by the company in writing.

Installation Procedure

1. Prior to installation please ensure that all the supply pipes have been flushed through to remove any debris and then ensure the water supply is turned off.
2. We strongly recommend the fitting of isolation valves to the inlet feeds for ease of future maintenance.
3. Ensure you have all the relevant tools before commencing the installation and take note of any specific markings on the product to make sure that they are installed correctly.
4. Carefully assemble new fittings onto deckware. Do NOT overtighten as this may cause damage to the fitting and/or the deckware. If you need to remove the Tap Handle to install the product, please take extra care when removing any Grub Screws/screws that secure the Handle in place. Once removed, simply pull on the Handle and it will come off. To access the Cartridge, simply unscrew the Dome Cap, untighten the locking nut and pull out the Cartridge.
5. Connect water supply to the inlet connectors and connect the Mixer unit to the spout (using the hoses supplied). Please ensure you take note of any specific markings on the product to make sure they are installed correctly.
6. Ensure fitting is in the 'open' position and turn on the water supply. Allow the tap to run for a few minutes to flush out any debris.
7. Check all water feed connections to ensure there are no leaks.
8. Check the assembled fit of the products to the deckware to ensure there is no water ingress that may cause water damage after installation.

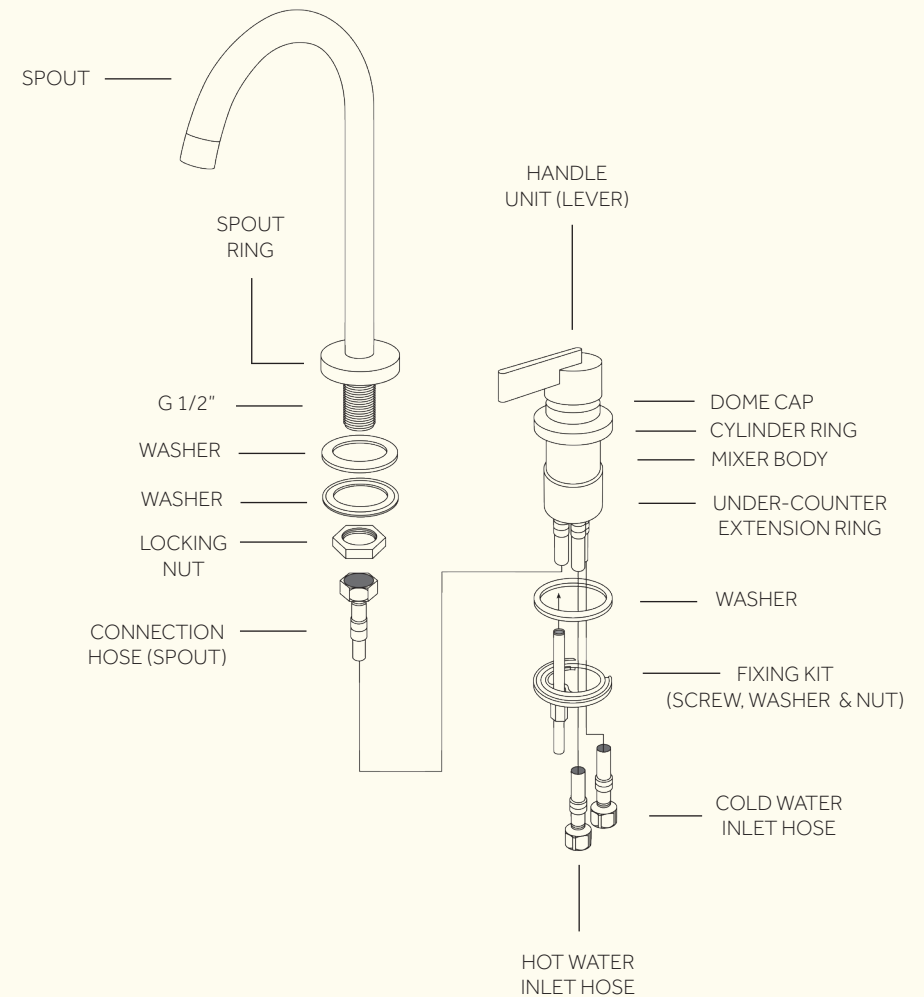

Min/Max Operating pressure: (bars)	0.5 - 5.0					
Flow rates: Bar/L per min (with Aerator)	0.5/3.8	1/5.4	1.5/6.6	2/7.6	2.5/8.5	3/9.3
Flow rates: Bar/L per min (without Aerator)	0.5/5.2	1/7.2	2/10	3/12.5	4/14.2	5/15.8
Connection:	1/2" BSP					
Flow Restrictor:	PCA TJ 8.0 LTR					

*Available with 'Back Plate' for fixing to front of wall. **Handle also available as Steam Wheel or Lever. Not shown in diagram.

INSTALLER DETAILS:

ORE